

baccarat®

HONG KONG

MAY 2011

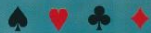

31

另附香港奢华指南

OPINION

WHY CHINESE PARENTS SHOULD BE MORE TAOIST

HOW IT'S NOT NORMAL TO BE A **VEGETARIAN****ART**

BIG-NAME GALLERIES SWOOP FOR OUR CASH

FAMOUS PAINTINGS BECOME **FASHION STATEMENTS**
**RYAN HUI &
JONATHAN WONG**
POP, PAPARAZZI & PORN

BITING THE BULLET

DONNIE YEN
**THE FAMILY MAN LAYS DOWN
HIS SWORD**

FASHION ♦ LUXURY ♦ LIFESTYLE

BACCARAT CONTENTS

MAY 2011

118



113 TIMEPIECES: For Rebels with Time on their Hands

118 JEWELLERY: Shining Stars

ART & DESIGN130 PHOTOGRAPHY: Metamorphic Bubbles
*By Christie Lee*134 ART: Fragile Creatures of the Night
By Christie Lee

137 ART: Fantasy to the Fore

138 DESIGN: No Frills

142 ON THE EDGE: Top Tables
By Carol Lin

156 DESIGN: Gin Becomes a Tonic

138

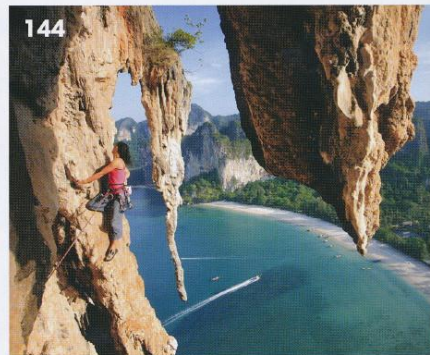

144

**LIFESTYLE**144 TRAVEL: 6 Extreme Asian Sojourns
*By Catharine Nicol*150 A WEEKEND AWAY: Wilson Kwok
Bordeaux152 TRAVEL: Waldorf Astoria Shanghai on the Bund
Steeped in History. *By Niall Chu*160 DINING OUT: Foodstuff
*By Andrew Dembina*164 DRINKING OUT: Bar Thrall
By Andrew Dembina

NO FRILLS

Founded by interior designer Ed Ng and architect Terence Ngan in 1999, AB Concept's work is subtle, serene and reverential in style, never showy. *Christie Lee* admires the award-winning studio's past and present projects.

Ed Ng and Terence Ngan of AB Concept. (Left) Ceiling detail at the Far Eastern Plaza hotel, Taipei



AB Concept founders Ed Ng and Terence Ngan's design philosophy is deeply anchored in their reverence for a place's history, culture and arts scene. Shunning token decoration and frill ornamentation, they have a penchant for the emotional play of light and proportion and the careful balancing of materials. Their successful formula is a combination of commercial savoir-faire and out-of-the-box thinking.

AB Concept's diverse portfolio encompasses hotels such as the W Retreat & Spa in Bali and the Mandarin Oriental Singapore, private residences including a show house in Giverny, France, restaurants, spas, offices, retail showrooms and the lobby of Pacific Place Three. The design studio's innovative approach is internationally recognised: it was honoured with the prestigious Illustrious Hospitality Design Award for the past two years – for Hotel Jen (now Traders hotel) and the French Window restaurant – as well as the 29th Annual Gold Key Award in the lobby/reception category for the Shangri-La's Far Eastern Plaza hotel in Tainan, Taiwan in 2009.



W Retreat & Spa, Bali



W Retreat & Spa, Bali

AB CONCEPT
tel: 2525 2428
website: www.abconcept.net

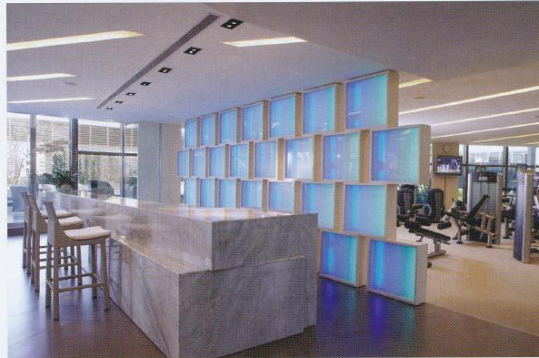

Spa at Shangri-La's Far Eastern Plaza hotel, Tainan

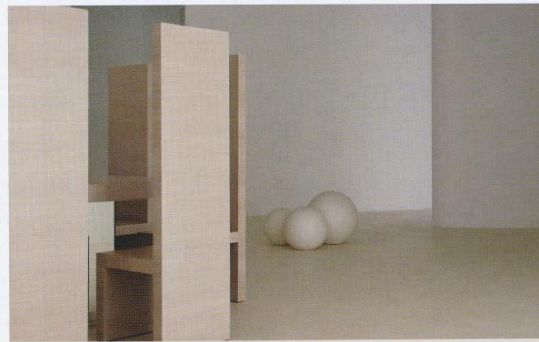

Green T. House



Show house, Giverny

SUBTLE ORIENTAL GLAMOUR

In one of its latest projects, AB Concept brings sophistication and glamour to Taiwan's fine dining and lounge scene. On the sixth floor of the Shangri-La's Far Eastern Plaza hotel in Taipei, Shang Palace plays host to a range of contemporary Cantonese dishes while Li Bai Lounge features premium Taiwan tea and cocktails.

"Many Chinese restaurants typically use crystal lighting and play up the 'bling' element to evoke a sense of luxury," says Ed Ng. "Instead, we wanted to create a serene, tranquil space using the Chinese motifs of the celestial cloud and peony flower. The Shangri-La attracts a sophisticated, worldly clientele who appreciate this subtlety."

The design studio envisioned two very different but complementary designs for Li Bai Lounge and Shang Palace. However, the process was not without obstacles, as Ng explains: "With a name like Shang Palace, we wanted the space to be palatial. However, we weren't working with one big open space. Instead, Shang Palace has low ceilings and is divided into smaller, more intimate rooms. Likewise, the Li Bai Lounge is shaped like a triangle so we had to work within the limitations of that space."

As with its previous projects, AB Concept's respect for Chinese history and Taiwanese culture is evident in the pinewood panels, earthy palettes and flower motifs. Bold Chinese motifs are set against a general atmosphere of serenity and dreaminess.

Designed with its namesake poet in mind, Li Bai Lounge projects an aura of sophistication and scholarly gravity. For that reason, Ng strove to create a scholarly setting with low lighting and dark woods. "We wanted to replicate a traditional Chinese scholar's pavilion. In these pavilions, the poet would ponder the world and find inspiration." By day, large windows open up the lounge giving it an airy atmosphere. By night, soft ambient lighting brings out its character and subtle textures.

6/F, Shangri-La's Far Eastern Plaza Hotel, 201 Tun Hwa South Road, Section 2, Taipei 106, Taiwan, website: www.shangri-la.com

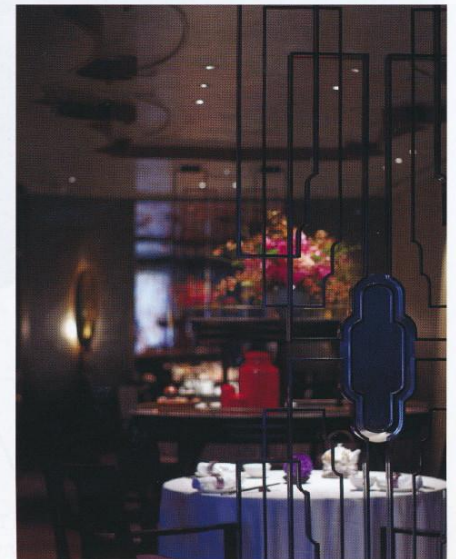

Shang Palace at Far Eastern Plaza hotel, Taipei